

Claremont Colleges

Scholarship @ Claremont

CGU MFA Theses

CGU Student Scholarship

Spring 5-18-2019

Unseen Forces

Rebecca Rich

Claremont Graduate University

Follow this and additional works at: https://scholarship.claremont.edu/cgu_mfatheses



Part of the [Art Practice Commons](#)

Recommended Citation

Rich, Rebecca, "Unseen Forces" (2019). *CGU MFA Theses*. 186.

https://scholarship.claremont.edu/cgu_mfatheses/186

This Thesis is brought to you for free and open access by the CGU Student Scholarship at Scholarship @ Claremont. It has been accepted for inclusion in CGU MFA Theses by an authorized administrator of Scholarship @ Claremont. For more information, please contact scholarship@claremont.edu.

REBECCA RICH

Unseen Forces

March 11-15, 2019

Reception-Tuesday, March 12, 6-8pm

Claremont Graduate University
East Gallery
251 East 10th Street
Claremont, CA 91711
(909) 621-8071

Gallery Hours: M-F 10am-5pm

Second Guess (Detail), 2018 Acrylic on canvas 36"x48"

Rebecca Rich

CGU MFA 2019

Unseen Forces

Artist Statement

My work belongs to a discussion of awareness and presentness. The foundation of the unconscious is the primary influence. The questions I am asking concern self-examination and self-reflection. I am working from a place that relates to the other and identities that would intersect with something and someone else: inter-objectivity. My art-making practice demands accountability with something greater than the personal. My work demonstrates that there is a shared space we intersect with. It sits between the end and the beginning, intuitively understanding that change is a constant with or without one's involvement or influence. My work is about connections and unseen experiences.

The questions I am asking are about irrefutable space vs refutable space, tangible vs intangible, real vs elusive, masculine and feminine, darkness and light. I explore these simultaneous pairs of opposites and allow them to remain unresolved. My work embraces the tension between these opposing forces but is not seeking balance. Implied in the work is that knowledge and acceptance of duality are required to enter. It is my responsibility to serve as a mediator between the spaces. The work serves as the path between. The paintings signify that it is time for the viewer to see with an intuitive eye rather than prioritizing the intellect and conscious mind. The work doesn't exist in a single moment, it is multiple moments at one time. It is the eternal now, the before and the after: simultaneity. The tension between two worlds but holding both at one time not a duality but a complete embracement of opposition standing in the tension.

My paintings are about relationships. Two (or more) things come together to create an entirely new thing that can only exist for the intersection. Like a forged connection, the moment of impact, the moment of creation, all things are created out of the merging of opposition. It is in this tension that life begins. This third thing is bigger than either thing on its own. If there is a structure and formality to each individual entity then the disrupting of each to engage with the other alters and reframes. The hybridity, this meeting point, is the in-between space where ideas meet. I seek the threshold moment of the meeting. The work is a demonstration of this meeting place. The viewer is a witness to the connection and can be a partner or a witness to co-creation.

I use layered mark making as a human language. My marks convey movement and rhythm and direction. The process of layering injects time into the surface. The marks are optical forces that encourage the viewer to move so there is interaction with the body. They invite the viewer to move and engage and challenge both the

body and the eye. It is relational work, there is a triangulation between me, the work and the viewer. This creates an indeterminate yet feeling experience, mystical sensation of time. The meaning isn't inherent in the work, the meaning arises out of the interaction with the viewer.

Unseen Forces

REBECCA RICH

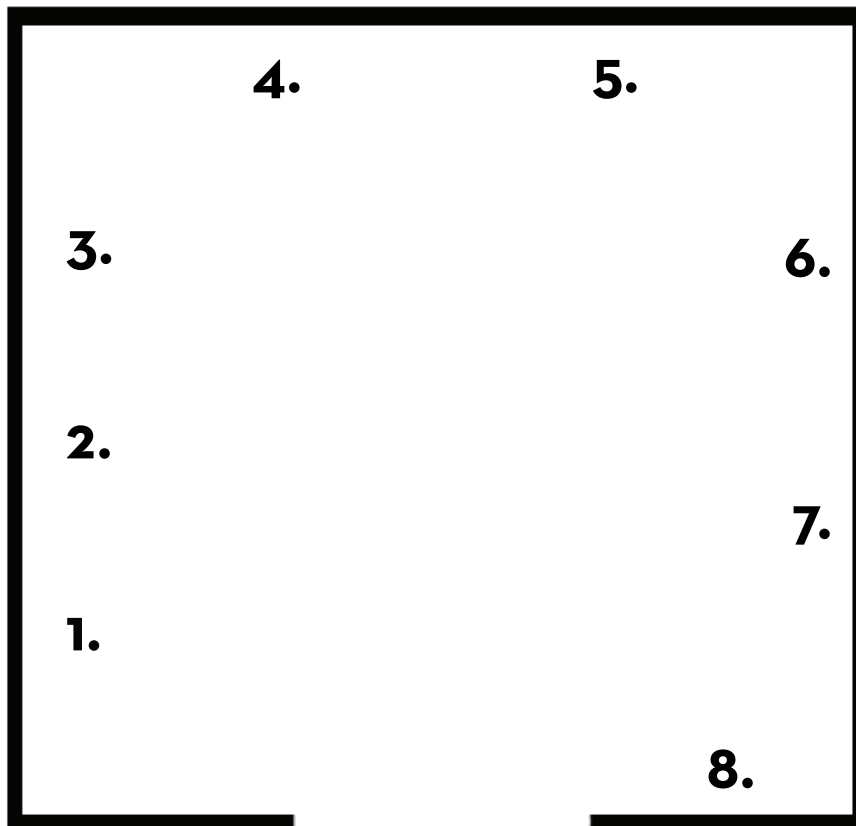

1. Baby Ghost, 2019 Acrylic on Canvas 60 x 60 inches
2. Where to Go, 2019 Acrylic on Canvas 60 x 60 inches
3. Tributaries, 2019 Acrylic on Canvas 60 x 60 inches
4. Soon, 2018 Acrylic on Canvas 132 x 144 inches
5. Stays Standing, 2019 Acrylic on Canvas 60 x 60 inches
6. The Deepest Ground, 2019 Acrylic on Canvas 60 x 60 inches
7. Secret Things, 2018 Acrylic on Canvas 138 x 126 inches
8. Ceremony, 2019 Acrylic on Canvas 60 x 48 inches

















